

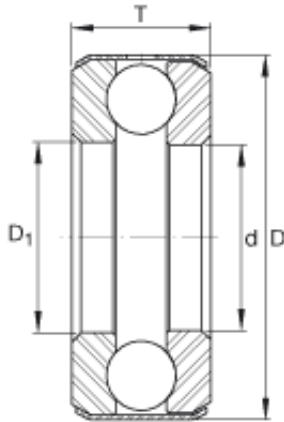

# China 608rs Bearing Supplier



D22 Bearing 2D drawings and 3D CAD models

## DAYCO POLY-V DRIVE BELT FOR NISSAN NAVARA D22 PATROL 3.0TD 7PK1640

Bearing No. D22

Size	46.038x78.588x20.65 mm
Bore Diameter	46,038 mm
Outer Diameter	78,588 mm
Width	20,65 mm
d	1 13/16 inch
d	46,038 mm
D	3,094 inch
D	78,588 mm
T	0,813 inch
T	20,65 mm
D <sub>1</sub>	1,844 inch
m	0,86 lbs / Weight
m	388 g / Weight
C <sub>a</sub>	10600 lbf / Dynamic load rating (axial)
C <sub>a</sub>	47000 N / Dynamic load rating (axial)
C <sub>0a</sub>	26500 lbf / Static load rating (axial)
C <sub>0a</sub>	118000 N / Static load rating (axial)
Category	Thrust Ball Bearing
Inventory	0.0
Manufacturer Name	SCHAEFFLER GROUP
Minimum Buy Quantity	N/A
Weight / Kilogram	0.465
Product Group	B00308



## China 608rs Bearing Supplier

Rolling Element	Ball Bearing
Thrust Bearing	Yes
Single or Double Direction	Single Direction
Banded	Yes
Cage Material	Steel
Precision Class	ABEC 1   ISO P0
Component Description	Roller Assembly Plus Raceways
Other Features	Single Row
Long Description	1-13/16" Bore 1; 1-27/32" Bore 2; 3-3/32" Outside Diameter; 13/16" Height; Ball Bearing; Single Direction; Banded; Steel Cage; ABEC 1   ISO P0 Precision
Inch - Metric	Inch
Category	Thrust Ball Bearings
UNSPSC	31171552
Harmonized Tariff Code	8482.10.50.08
Noun	Bearing
Keyword String	Ball Thrust
Manufacturer URL	<a href="http://www.ina.com">http://www.ina.com</a>
Weight / LBS	0.862
Bore 1	1.813 Inch   46.05 Millimeter
Overall Height with Aligning Washer	0 Inch   0 Millimeter
Bore 2	1.844 Inch   46.838 Millimeter
Height	0.813 Inch   20.65 Millimeter
Outside Diameter	3.094 Inch   78.588 Millimeter